

## SECTION I

## INTRODUCTION

## 1-1. GENERAL.

1-2. This Parts Catalog lists and describes, in disassembly order, all installations, assemblies, and detail parts of the model S-58T helicopter manufactured by Sikorsky Aircraft, Division of United Technologies Corporation, Stratford, Connecticut, 06602.

1-3. This Parts Catalog is divided into the following sections:

Table of Contents  
Section I Introduction  
Section II Group Assembly Parts List  
Section III Numerical Index

## 1-4. SIKORSKY PARTS NUMBERING SYSTEM.

Sikorsky part numbers are assigned so that it is possible to tell from the part itself the particular group of the specific helicopter to which it applies. In any part number, the first two digits together designate the helicopter model; the next two digits designate the group; the next five digits designate the assembly number; the final dash number designates the detail part of the assembly. For example, part number S1620-72210-1; 16 indicates that the part applies to the model S-58T helicopter, 20 designates the Fuselage Group, 72210 is the number of the assembly drawing and the -1 identifies the correct detail on the assembly drawing. Listed below are the group designations applying to the S-58T model helicopter:

S1610-10000	Main Rotor and Tail Rotor
S1615-20000	Main Rotor Blade and Tail Rotor Blade
S1620-70000	Fuselage
S1625-50000	Landing Gear
S1630-80000	Demountable Power Plant
S1635-64000	Transmission
S1640-61000	Flight Control
S1645-61000	Instrument
S1650-60000	Furnishing
S1655-61000	Electrical
S1665-20000	Hydraulic
S1690-60000	Automatic Stabilization Equipment

1-5. PREVIOUS MODEL NUMBERS. Throughout the Group Assembly Parts List and the Numerical Index, certain other Sikorsky numbers are found which do not conform to the numbering system as previously described. These numbers were originally designed to be used on an earlier model helicopter but were found adaptable to the S-58T.

Listed below are examples of these part numbers:

S10-10-6445  
S12-20-2325  
S14-35-4401  
S1520-62410  
S6230-63010

1-6. NEW MODEL NUMBERS. The Group Assembly Parts List and Numerical Index also contain Sikorsky numbers for a model originating after the S-58T; however, these part numbers are adaptable to the S-58T. These numbers are not preceded by "S" but otherwise conform to the numbering system described in paragraph 1-4 of this Introduction. 6415-20004-013 is an example of this type number.

1-7. SIKORSKY STANDARDS AND SIKORSKY BEARINGS. Part numbers which do not conform to any of the numbering systems previously described, and cannot be identified as Government Standard or vendor parts, are either Sikorsky Standards or Sikorsky Bearings. For example, SS4056-6-263 is a Sikorsky Standard Part and SB1057-1 is a Sikorsky Bearing.

1-8. Figure 1 is an exploded view of the model S-58T helicopter which can be used as a visual index to the group breakdown of helicopters.

1-9. SPECIAL TOOLS AND SUPPORT EQUIPMENT. Special tools and support equipment may be found in S-58T Maintenance Manual SA4047-21.

## 1-10. TABLE OF CONTENTS.

1-11. The Table of Contents of this Parts Catalog shows the method of grouping the parts and the sequence of the groups. The pages listed are the page numbers of the applicable illustration.

## 1-12. SECTION II GROUP ASSEMBLY PARTS LIST.

1-13. Section II lists all parts of the helicopter which are requisitioned, stored, and issued. The listings of helicopter parts are arranged continuously in disassembly breakdown order, with the applicable illustration placed as near as possible to, or directly above the listing.

1-14. FIGURE AND INDEX COLUMN. The first number in the "FIGURE & INDEX NUMBER"

column refers to the illustration, and the second number refers to the location of the part on the illustration.

1-15. PART NUMBER COLUMN. This column contains the part number of each Government Standard, vendor, or Sikorsky part. If the item listed is a commercial part, and a part number has not been designated, "COML" will appear in the "PART NUMBER" column.

1-16. NO NUMBER ASSEMBLIES. The term "No Number," as found in the "PART NUMBER" column, has two applications. The first applies to vendor items identified only by type number, stock number, etc. Complete information as to these identifying numbers is found following the description of the item. The second applies to Sikorsky items and signifies those items which are left from any assembly carrying a Sikorsky or vendor part number after a maintenance breakdown has been made. No Numbers, in this instance, are always a group of riveted, staked, soldered, or welded parts forming a riveted, staked, soldered, or welded assembly for which there is no number assigned.

1-17. This Parts Catalog utilizes the following symbols in the "PART NUMBER" column: The symbol (□), (@), (\$), (%), (&), or combination thereof indicates a footnote at the bottom of a page. In some cases, part numbers are preceded by the symbol (#) which designates matched sets. The symbol (\*) denotes nonprocurable parts and is shown as "NP" in the "UNITS PER ASSY" column.

1-18. DESCRIPTION COLUMN. This column lists the complete description of each item by the Government Standard, vendor, or contractor's drawing title.

1-19. INDENTION SYSTEM. For the proper identification of details, and next assemblies, the listings are in a convenient indention system. The indention system is in accordance with the following outline:

1 2 3 4 5 6 7

INSTALLATION

ASSEMBLY

ATTACHING PARTS FOR ASSEMBLY

\*\*\*\*\*

SUBASSEMBLY

ATTACHING PARTS FOR SUB-

ASSEMBLY

\*\*\*\*\*

DETAIL PARTS

ATTACHING PARTS FOR DETAIL

\*\*\*\*\*

The detail parts of any installation, assembly, or subassembly is shown one column to the right; therefore, the next higher assembly of any detail part may be determined by locating, in the next column to the left, excluding any attaching parts, the first item above the detail in question.

1-20. ATTACHING PARTS. Attaching parts appear in the same indention column immediately following the item they attach and preceding any components of that item. A long horizontal dash (terminal dash) appears in the "DESCRIPTION" column under the last attaching part of any item.

1-21. Section II includes some parts which are not stocked or procured but have been listed because they facilitate location and identification of related procurable or stocked parts. In the breakdown of an assembly, if a part is not listed, the part is not procurable as a separate item. In certain instances, a nonprocurable part is illustrated to clarify exploded views of procurable parts. Nonprocurable parts, illustrated, are rendered as "phantom" or "ghost" items without index numbers, as shown in the sample illustration.

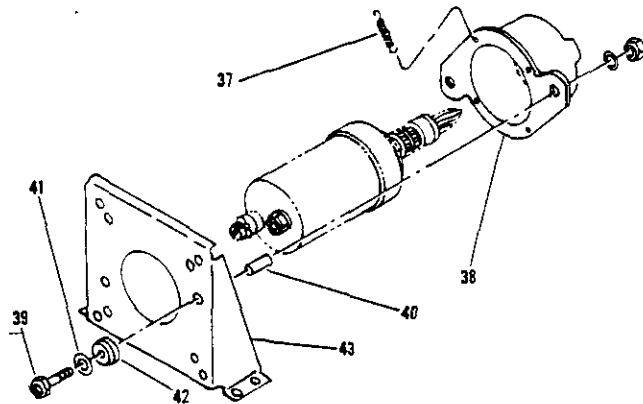

1-22. MANUFACTURERS' CODE SYMBOLS. A complete list of the manufacturers' names, addresses, and code symbols, arranged numerically by code, is included in paragraph 1-23 of this Introduction. The codes are identical to those shown in Cataloging Handbooks H4-1, and H4-2, Federal Supply Code for Manufacturers.

1-23. The name of the manufacturer of commercially furnished equipment is inserted throughout Section II, Group Assembly Parts List, by code. This code follows the description of the item and consists of a five digit number within parentheses. Reference to the following code list will explain any code used in this Parts Catalog:

1-24. The term left-hand (LH) and right-hand (RH), used throughout the DESCRIPTION column refers to the helicopter as viewed from the pilot's seat.

1-25. UNITS PER ASSEMBLY COLUMN. The number in the UNITS PER ASSY column is the total quantity of an assembly used per helicopter at the location indicated. The detail parts indented under the assemblies indicate the quantity used per assembly, but are not necessarily the total used per helicopter.

1-26. Section II also includes AR, NP, and REF, which are found in the UNITS

PER ASSY column. AR signifies that the quantity is to be selected to fit as required on assembly; NP means the part is non-procurable; and REF indicates that the item has been listed elsewhere in the catalog. Complete cross reference will be found following the description of the part.

1-27. SIMILAR ASSEMBLIES. When left and right-hand, forward and aft, or similar assemblies contain a majority of identical parts, they are broken down together. When there are a number of different parts, they are broken down separately for clarity. In instances where similar assemblies

are broken down together, the total number of attaching parts needed for any two or more such assemblies are shown, but only the quantity of detail parts for a single assembly is shown.

1-28. USABLE ON CODE COLUMN. When no code is shown, the part is used on all helicopters covered by this Parts Catalog.

1-29. SECTION III NUMERICAL INDEX.

1-30. PART NUMBER COLUMN. This column lists in alphabetical and numerical sequence, all Government Standard, vendor, and sikorsky part numbers required to maintain the model S-58T helicopter.

1-31. PART NUMBER ARRANGEMENT. The part numbers are arranged from the extreme left-hand position and continue from left to right, one position at a time, until all parts are arranged in sequence. The order of precedence for the extreme left (first) position is as follows:

Letters A thru Z, then  
Numerals 0 thru 9.

The order of precedence in continuing the part number arrangement on the second and succeeding positions of the part number from left to right is as follows:

Space (blank column)

Diagonal (slant)

Point (period)

Dash (-)

Letters A thru Z, then,

Numerals 0 thru 9.

Note

Alphabetic (letter) 0's are listed as numerical zeros.

1-32. No Number and commercial (COML) parts are listed in the PART NUMBER column and are arranged in alphabetical sequence by the identifying noun.

1-33. FIGURE AND INDEX NUMBER COLUMN. This column, showing the figure and index number of parts, serves as a key to where the parts are illustrated and listed in the Group Assembly Parts List. For Government Standard Parts, only the figure number and index number of their first appearance will be listed.

1-34. QUANTITY PER ARTICLE COLUMN. This column contains the total quantity of each part per helicopter. If the total quantity per assembly is desired, refer to Section II Group Assembly Parts List. The symbols AR, NP, and REF are also found in these columns. AR indicates that the quantity is to be selected to fit as required, NP denotes nonprocurable parts and REF indicates that the same item has been listed more than once in the Group Assembly Parts List. Refer to the figure and index column as a key to complete cross reference in Section II of this catalog.

1-35. SECTION III SUPPLEMENTAL NUMERICAL INDEX. This supplemental numerical index contains Government Standard, vendor, and Sikorsky part numbers added to this Parts Catalog by the incorporation of Revision No. 2.

1-36. ORDERING AND RETURNING PARTS.

a. Parts Catalogs are furnished to all operators. These catalogs contain illustrated parts breakdown of all major components and assemblies to assist operators in securing replacement parts.

b. Ordering Parts. Replacement parts should be ordered from the current Parts Catalog. All orders for replacement parts should be addressed to Spares Manager, Product Support Department, Sikorsky Aircraft, Stratford, Connecticut, 06601.

c. Returning Parts. Before returning parts for overhaul, repair, examination, inspection, or credit, information must be furnished as designated

below in order that a Returned Material Authorization (Form SA 619-1) may be processed to the operator.

Information Required:

1. Part number
2. Part name
3. Quantity to be returned
4. Serial number (if any)
5. Total time on part
6. Time since last overhaul
7. Reason for return

Address to Department Affected:

1. Commercial Customer Service Dept.  
Product Support (Service) Department,  
Stratford, Connecticut.  
All material being returned for  
examination, inspection, or possible  
warranty consideration.
2. Commercial Overhaul and Repair De-  
partment,  
South Ave., Bridgeport, Connecticut.  
All material being returned for  
overhaul and/or repair.
3. Commercial (Spares) Department,  
Stratford, Connecticut.  
All new material received in error.  
  
d. Upon receipt of the Returned Material Auth-  
orization (RMA) fill in a Commercial Customer's  
Check-Off List (Form SA 600). Enclose the green  
and white copies of the form SA 600 with your  
packing slip when returning parts to Sikorsky Air-  
craft. A separate RMA form 619-1 and form  
SA 600 are required for each shipment of parts or  
assemblies being returned. Additional copies of  
form SA 600 may be obtained from the Product  
Support (Service) Department.